

NOTES

FIRE SAFETY EQUIPMENT

- ① Fire Extinguisher
- ② Fire Extinguisher
- ③ Fire Extinguisher
- ④ Fire Extinguisher
- ⑤ Fire Extinguisher
- ⑥ Fire Extinguisher
- ⑦ Fire Extinguisher
- ⑧ Fire Extinguisher
- ⑨ Fire Extinguisher
- ⑩ Fire Extinguisher
- ⑪ Fire Extinguisher
- ⑫ Fire Extinguisher
- ⑬ Fire Extinguisher
- ⑭ Fire Extinguisher
- ⑮ Fire Extinguisher
- ⑯ Fire Extinguisher
- ⑰ Fire Extinguisher
- ⑱ Fire Extinguisher
- ⑲ Fire Extinguisher
- ⑳ Fire Extinguisher
- ㉑ Fire Extinguisher
- ㉒ Fire Extinguisher
- ㉓ Fire Extinguisher
- ㉔ Fire Extinguisher
- ㉕ Fire Extinguisher
- ㉖ Fire Extinguisher
- ㉗ Fire Extinguisher
- ㉘ Fire Extinguisher
- ㉙ Fire Extinguisher
- ㉚ Fire Extinguisher
- ㉛ Fire Extinguisher
- ㉜ Fire Extinguisher
- ㉝ Fire Extinguisher
- ㉞ Fire Extinguisher
- ㉟ Fire Extinguisher
- ㊱ Fire Extinguisher
- ㊲ Fire Extinguisher
- ㊳ Fire Extinguisher
- ㊴ Fire Extinguisher
- ㊵ Fire Extinguisher
- ㊶ Fire Extinguisher
- ㊷ Fire Extinguisher
- ㊸ Fire Extinguisher
- ㊹ Fire Extinguisher
- ㊺ Fire Extinguisher
- ㊻ Fire Extinguisher
- ㊼ Fire Extinguisher
- ㊽ Fire Extinguisher
- ㊾ Fire Extinguisher
- ㊿ Fire Extinguisher
- ⚠ Fire Blanket
- ⚡ Fire alarm call point

Note:
All fry stations have automatic fire suppression devices fitted.

Licenable activity:
Sale of Hot food & Drink
after 11pm.

Rev: _____
Date: _____
Project: _____

8315 Harwich
Teardrop Site,
Williamsburg Avenue,
Harwich
CO12 4GA

Ground floor plan
(For Licencing)

Date:	Oct 2018	Drawn by:	C.T.S.G.	Checked by:	Arch
Scale:	1:100	Project No.:	L8315/001	Sheet No.:	001
DWG:	1:100@A3				

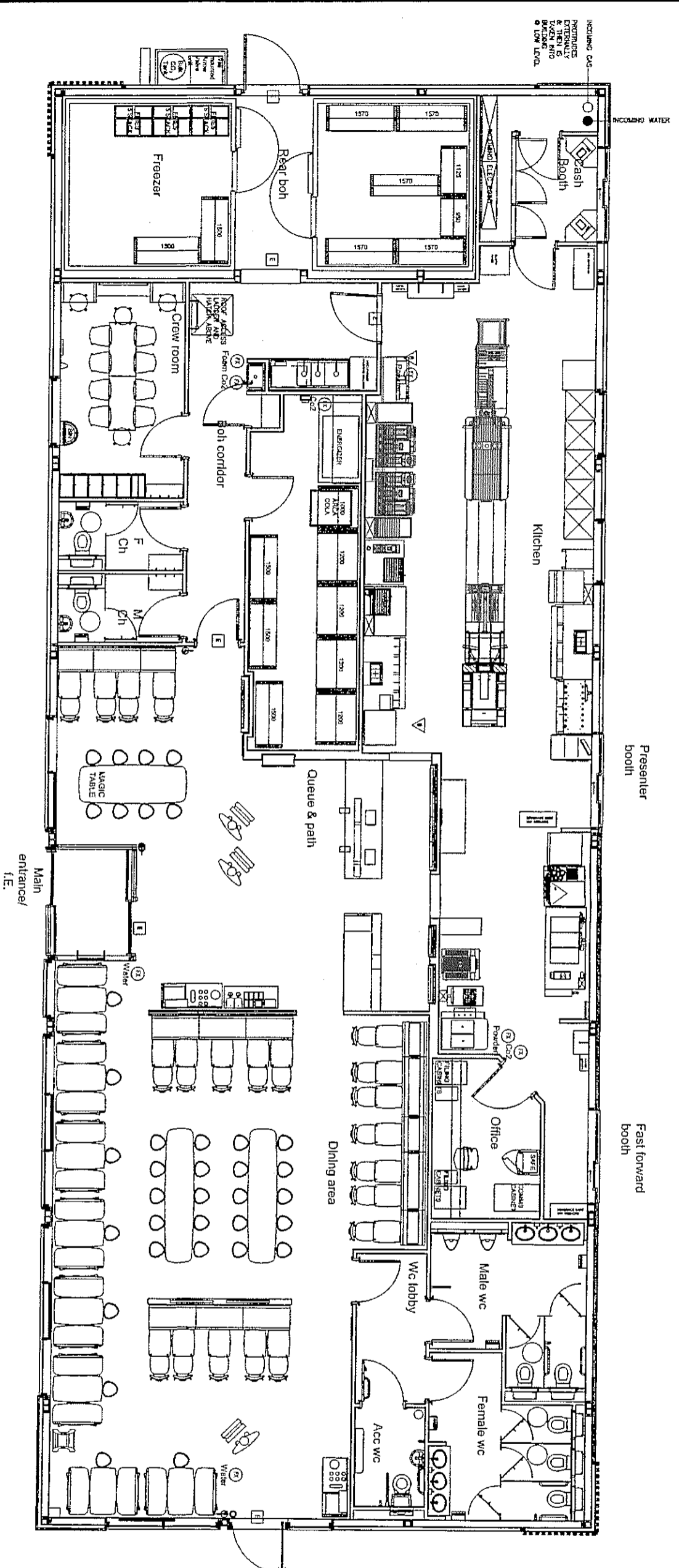

INCUBATING CASES
PREPARED
EXTERNALLY
& THEN IS
BROKEN & SERVED
ON LOW LEVEL

INCUBATING WATER

Presenter booth

Fast forward booth

Kitchen

Queue & path

Dining area

Office

Male wc

Female wc

W/c lobby

Acc wc

Rear boh

Freezer

Crew room

Boh corridor

Magic table

Main entrance/f.e.